

TWO LAMP WALL BRACKET

CATALOG NO.	LAMPS	BALLAST	POWER FACTOR	LENGTH	WIDTH	DEPTH	PCS/CTN	UNIT WT.
2215 C TS	2-15W	Trigger	Low	18 1/4	3-1/4	5-1/4	2	4
2220 C TS	2-20W	Trigger	Low	24 1/4	3-1/4	5-1/4	2	5
2230 C RS	2-30W	Rapid	High	36 1/4	3-1/4	5-1/4	2	10
2240 C RS	2-34W	Rapid	High	48 1/4	3-1/4	5-1/4	2	10

- ⊘ Housing and ends are die-formed steel, finished with chrome plating.
- ⊘ Diffuser made of milk-white ribbed polystyrene.
- ⊘ Smooth acrylic diffuser available upon request.
- ⊘ Switch (pull and push) and convenient outlet available upon request.



2200 SERIES

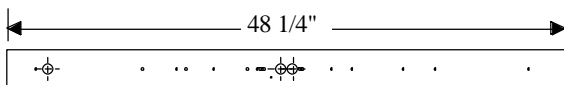
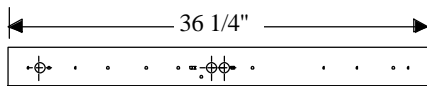
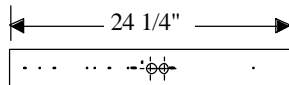
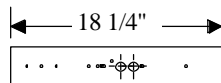
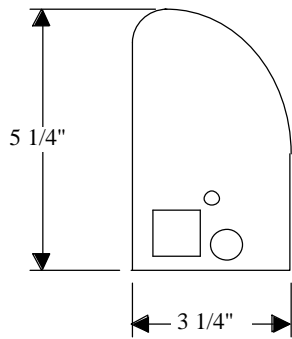
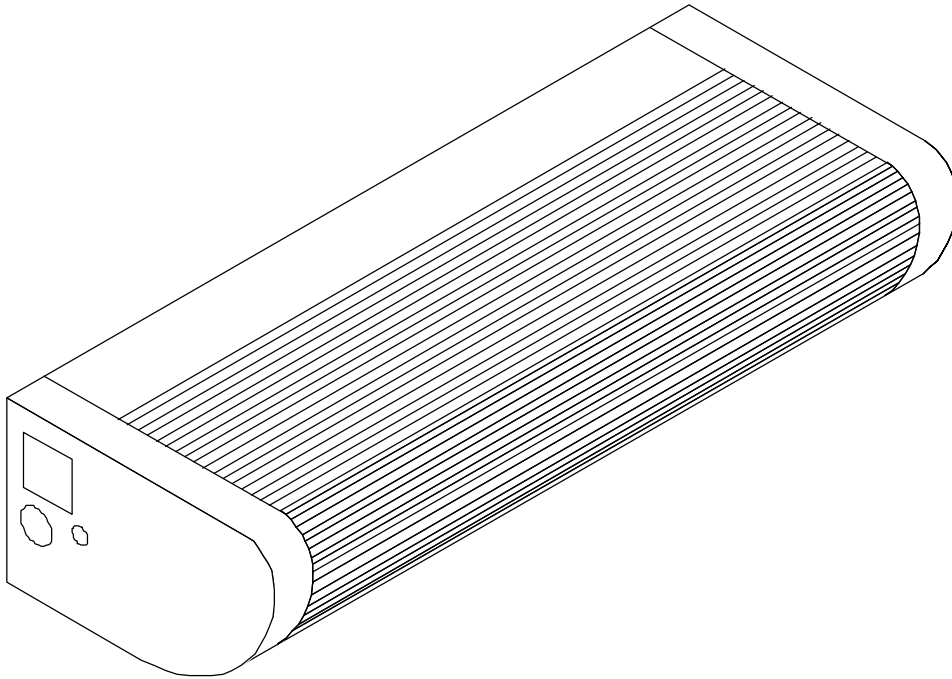

MOUNTING - Complete with knockouts for surface mounting. Conduit knockouts are supplied on back.

ELECTRICAL - Furnished standard with UL listed ballasts, for 120 Volt 60 Hz A.C. operation. Other voltages and accessories available. Fixtures bear the I.B.E.W., A.F. of L., and Underwriters' Laboratories, Inc. labels.

APPLICATION - An ideal unit for lavatories, corridors and utility areas. Suitable for wall or ceiling mounting, can be mounted vertically or horizontally.

CONSTRUCTION - Wireway and ends die-formed of code gauge steel, finished in polished chrome-plated steel. Reflector is removable for easy access to electrical components. Other finishes available upon request.